

FED. ROAD DIST. NO.	STATE	JOB PIECE NO.	FISCAL YEAR	SHEET NO.	TOTAL SHEETS
6	OKLA.				
DESCRIPTION		REVISIONS		DATE	

SHEET ESTIMATE I  
 STA. 73+00.00 TO STA. 78+24.34  
 UNCL. EXCAV = 773 CY  
 EMB + 15% = 2,049 CY  
 UNCL BORROW = 1,276 CY

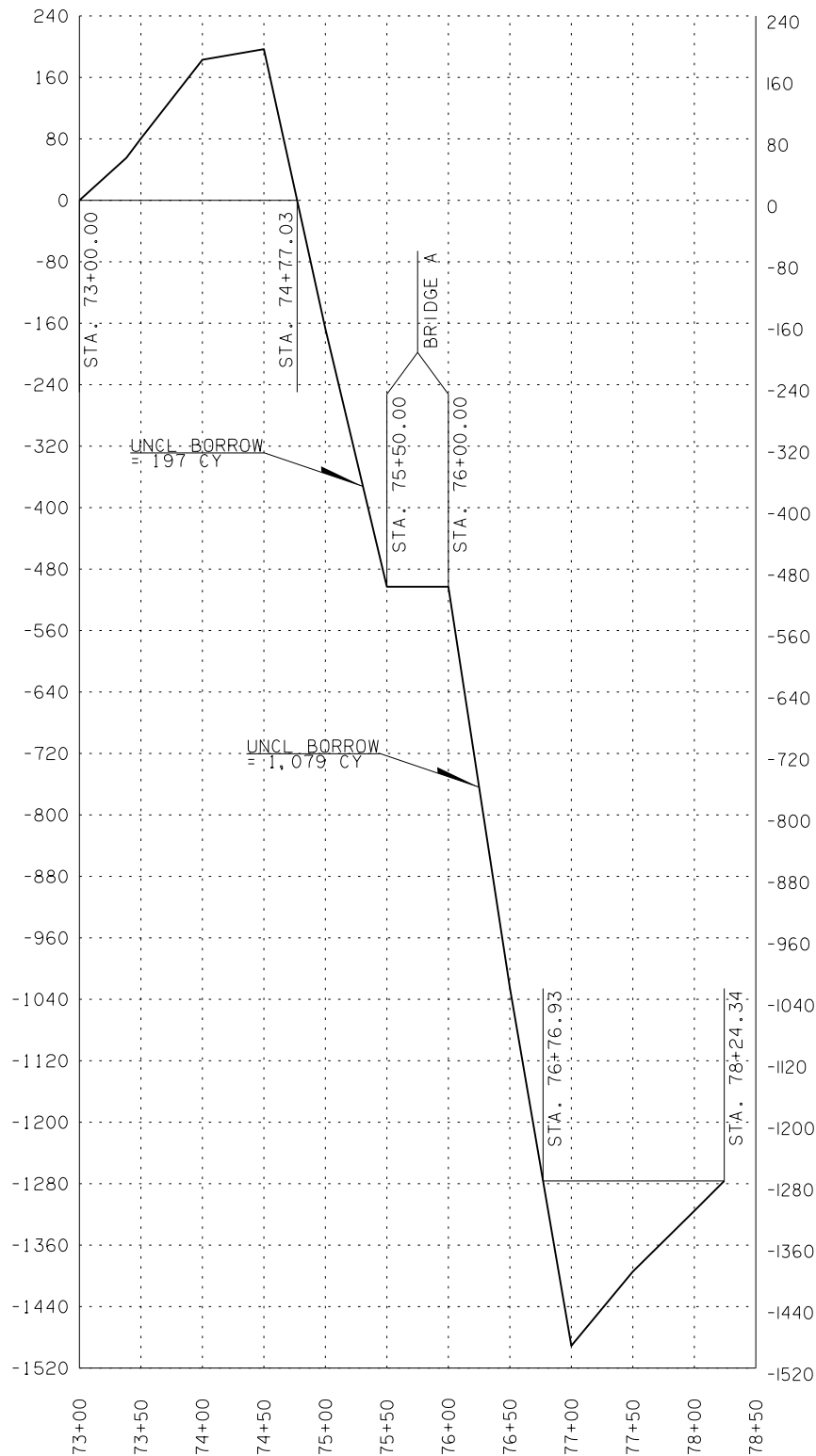

PHASE 1  
 STA. 73+00.00 TO STA. 78+24.34

SHEET ESTIMATE II			
Station To Station	UNCLASSIFIED EXCAVATION 202(A)	EMBANKMENT +15%	UNCLASSIFIED BORROW 202(D)
	C.Y.	C.Y.	C.Y.
73+00.00 TO 78+24.34	773	2,049	1,276

Y:\Division 2\Projects Moved to Project Wise\Bryan 27912 (04) \Draft\27912 (04) -Mass Diagram.dgn

MASS DIAGRAM PROVIDED FOR BIDDING PURPOSES ONLY. ACTUAL BALANCE POINTS TO BE DETERMINED BY CONTRACTOR AND VOLUME OF MATERIAL ENCOUNTERED DURING GRADING OPERATIONS. WHENEVER POSSIBLE, THE CONTRACTOR SHALL SEQUENCE EARTHWORK OPERATIONS IN ORDER TO OBTAIN THE MATERIAL FROM THE CUT SECTION FOR USE AS FILL RATHER THAN OBTAINING UNCLASSIFIED BORROW. MATERIAL DEPICTED AS WASTE SHALL ONLY BE CONSIDERED WASTE ONCE ALL EARTHWORK OPERATIONS HAVE BEEN COMPLETED. THIS MATERIAL SHALL BE USED TO REDUCE THE NEED FOR UNCLASSIFIED BORROW AT ANY LOCATION AND TIME THROUGH THE DURATION OF THE PROJECT.

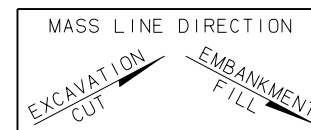

DESIGN	KN
DRAWN	KN
CHECKED	
APPROVED	
SQUAD	JONES

OKLAHOMA DEPARTMENT OF TRANSPORTATION  
 ROADWAY DESIGN DIVISION

MASS DIAGRAM